

TYPES KC-J12, EQC632C

Transformer Ground Connectors

For Copper

Fits all standard EEI-NEMA distribution transformers as tank grounding terminal.

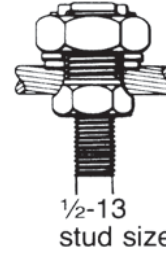

Type KC22B2

1/2-13
stud size

Catalog Number	Ranges
KC22J12T13	8 Sol. - 2 Sol.
KC26	2 Sol. - 2/0 Str.
KC34J12T13	3/0 - 500 Str.
EQC632C	8 Sol. - 2 Str.

TYPE KS

SERVIT®

For Copper

UL467 Listed for direct burial applications in earth or concrete. Compact, highstrength, high copper alloy SERVIT® split-bolt has free-running threads and easy to grip wrench flats. Highly resistant to cracking and corrosion.

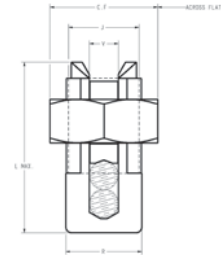

Catalog Number	Cross Flats	L	W	Copper Conductor Range	Rebar with (1) #8 Sol. Cu	Recommended Tightening Torque (in-lb)
KS15	0.50	0.85	0.38	10 - 8 Str.	14 Str.	80
KS17	0.63	1.14	0.45	8 Str. - 6 Sol.	14 Str.	165
KS20	0.69	1.20	0.51	8 Str. - 4 Sol.	14 Str.	165
KS22	0.75	1.50	0.60	6 Str. - 2 Sol.	14 Str.	275
KS23	0.82	1.54	0.62	6 Str. - 2 Str.	14 Str.	275
KS25	0.94	1.77	0.73	4 Str. - 1/0 Str.	14 Str.	385
KS26	1.05	1.94	0.82	2 Str. - 2/0 Str.	14 Str.	385
KS27	1.36	1.86	1.17	1 Str. - 3/0 Str.	8 Sol.	500
KS29	1.36	2.07	1.17	1 Str. - 250	8 Str.	650
KS31	1.70	2.51	1.41	1/0 Str. - 350	1/0 Str.	650
KS34	1.82	2.79	1.48	2/0 Str. - 500	2/0 Str.	825